

MISCELLANEOUS blades, cords & sealant

SABERCUT CARBIDE BLADES



Regular or teflon coated.

ID	Specification	Size
BLADECARSC24T71401	24T	7-1/4"
BLADECARSC24T714TC	24T Teflon Coated	7-1/4"

DURAFLEXX EXTENSION CORDS



Single or triple tap.

ID	Specification
CORDEXT100UF123	100' x 12/3
CORDEXT50UF123	50' x 12/3
CORDEXT100DF143	100 ft x 14/3 Lighted ends
CORDEXT50DF143	50 ft x 14/3 Lighted ends
CORDEXT32DF143	32.8 ft x 14/3 Lighted ends
CORDEXT100DF123TT	100 ft x 12/3 Triple Tap Lighted ends
CORDEXT50DF123TT	50 ft x 12/3 Triple Tap Lighted ends

SILICONE BATH, KITCHEN & GENERAL PURPOSE SEALANT



- ◆ Premium Quality 100% Silicone Sealant That Remains Permanently Flexible
- ◆ Other Colours Available
- ◆ 300ml Tube

ID	Specification	Packaging
SILICONECLEBK	Clear	12/Case

MISCELLANEOUS | housewrap, tarps & brackets

TYPAR HOUSEWRAP



- ◆ 9' x 100'
- ◆ Duradrive Label

ID	Specification
HOUSEWRAPTYP9100DSI	9' x 100'

HEAVY DUTY CONSTRUCTION TARPS



- ◆ High Density Polyethylene 10 x 10 Weaving
- ◆ 110 gram
- ◆ Clear
- ◆ Water Resistant
- ◆ Double Stitched
- ◆ Reinforced Corners

ID	Specification
TARP1520IHL	15' X 20'
TARP2030IHL	20' X 30'
TARP3050IHL	30' X 50'

SAFETY RAIL BRACKETS



- ◆ Easy to Install
- ◆ Easy to Dismount & Move to Another Job Site
- ◆ Powder Painted Safety Yellow
- ◆ Comes with Extra Reinforced Base & 6 Screw Holes

ID	Specification
BRACKETSAFRAI	Safety Rail Bracket

DOVETAIL ANCHOR SLOTS BRICK TIES

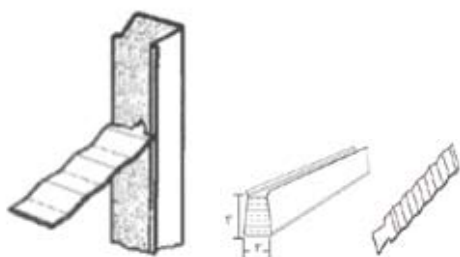

With a heavy, galvanized coating to prevent corrosion, Dovetail Anchors have deep corrugations to increase pull out strength.

- Anchor Slot and Dovetail Anchors provide a permanent, fast, flexible and cost effective method of anchoring brick, stone and block to cast-in-place concrete walls and columns
- Provides an excellent anchoring system for both cast-in-place and precast concrete
- Manufactured in 16 gauge hot dipped, galvanized steel

ID	Specification	Packaging
DOVETAIL	16G, HDG	200'/Bdl

BRICK TIES

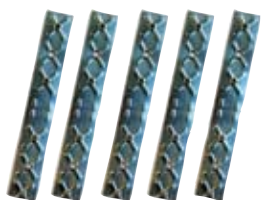

ID	Specification	Packaging
BRICKTIES17	22G Galvanized 1" x 7"	500/Bx

DURAMESH EIFS STUCCO FIBERMESH



White or blue fiber mesh.

ID	Specification	Packaging
FIBERMESHBLU	38" x 50Yds 4.5Oz	40Rl/Sk
FIBERMESHWHI	38" x 50Yds 4.5Oz	40Rl/Sk
TAPEFIBMES500	2" x 500'	

PVC WATERSTOPS

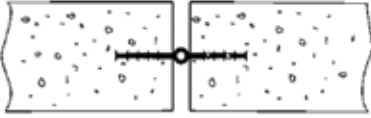
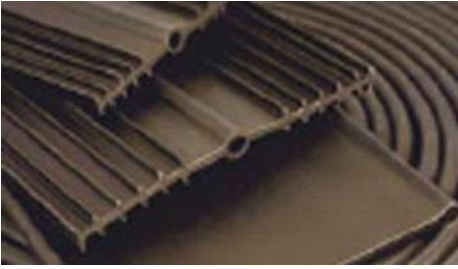

♦ WATERSTOP4

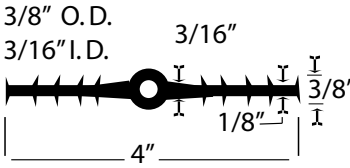

♦ WATERSTOP6

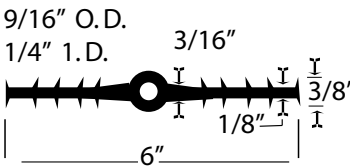

Used in expansion joints where normal movement between members is anticipated.

ID	Specification
WATERSTOP4	4" X 50'
WATERSTOP6	6" X 50'

WASHERS FOR STUCCO



Washers used for Stucco Insulation EIFS System.

ID	Specification	
STUCCOWASNIP	Washers With Nipple	1MPc/Bx
STUCCOWASFLA	Flat Washers	1MPc/Bx